



VICTORIAN LAMP POST
***with* CENTRAL SOLAR PANEL**
and GS SOLAR LED BULBS

US Patent # 7172307, 9458970

Instruction Manual

Model: GS-94B-CD



Visit our website or download the latest version of your instruction manual:

www.gamasonic.com or www.gamasonic.com/user-guides

Introduction

Thank you for your purchase. **GAMA SONIC**® solar charged accent lighting eliminates the problems associated with most solar lighting available today.

GAMA SONIC® solar charged lights are brighter and last all night with a typical solar charge. Unique design, superior light output and numerous installation options confirm the outstanding value of our product.

GAMA SONIC® has been recognized as a worldwide leader in the lighting industry for over 20 years. The company also offers unique multi-purpose rechargeable products that range from party lights to emergency lighting products.

For technical assistance and more information call our Toll Free number: 800-835-4113 (only within the US) or visit our website at: www.gamasonic.com.

Please read the instruction manual carefully to obtain the best results from your purchase.

Solar Lamp Post Location

For optimum light duration throughout the night, it is very important to place your solar lamp in a spot where it will receive the maximum amount of direct sunlight throughout the day.

NOTE: For best results, the solar lamp post must be charged for two sunny days on the "ON" position,

WARNING: GAMA SONIC® Light bulbs are built and designed for Gama Sonic products only. They are not designed to be used in other electrical sockets. For the same reason, regular AC and/or Low Voltage bulbs cannot be used in Gama Sonic products.

Please read the instruction manual carefully to obtain the best results from your purchase.

Note:

Before drilling anywhere consult with a contractor.

WARNING

Do not dispose of Li-Ion battery in the regular trash, municipal waste stream or by fire as batteries may leak or explode. Do not open, short circuit, or mutilate batteries as injury may occur. Preserve our environment by recycling Li-Ion batteries or disposing of them in accordance with local, State and federal regulations. Do not mix old and new batteries.

Maintenance

Clean the solar panels regularly with a damp towel to guarantee optimum performance. Do not use any type of solvent for cleaning and be careful not to put too much pressure on the solar panels while cleaning.

Troubleshooting

If your solar charged light does not come on at dusk despite observance of all the instructions, please try the following steps:

1. Make sure that the solar lamp is not being affected by any other light source.
2. Ensure the solar lamp is not positioned in the shade during the day.
3. Make sure the switch in the lamp head is in On (Summer or Winter) position.
4. Check that the batteries are installed correctly.

Note: *The performance of the solar lamp will vary with the time of year. It will deliver more light when it has had a full day in the sun rather than a day in overcast weather.*

WINTERTIME TIPS

For optimal performance, be sure to remove any snow or debris accumulation from solar panel(s). A solar panel free of debris will charge the batteries much more efficiently.



WARNING

Please keep out of reach of children.

Operation Instructions

Make sure that the lamp is turned to the "high" or "low" position as shown below. (**Low** - lasts longer using dimmer light. **High** - Brighter light output.)



Replacing the Batteries

(After several years of use, the battery may need replacing).

1. Remove the battery cover from Part B.
2. Disconnect the clip connecting the battery to the lamp and clip in the new battery. Make sure the new battery is a Gama Sonic 3.2V/6,000mAh Lithium-Ion Rechargeable battery with connector. (Part #GS32V60)
3. Place the battery in the compartment on the back side of the battery door and hold it against Part B while screwing it back into place.

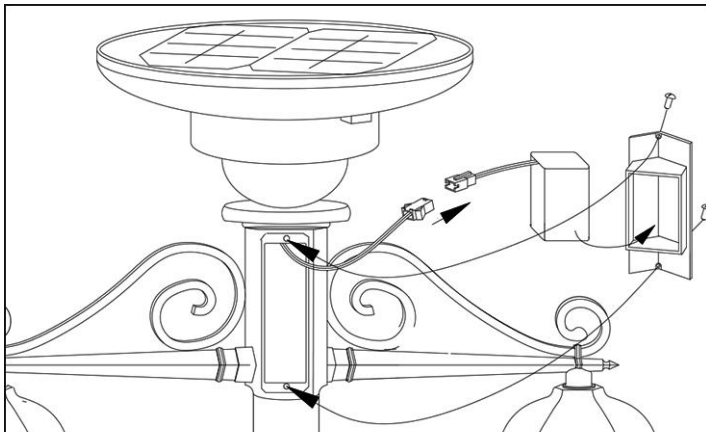

What's Inside?

Open your package and remove the contents. Check to make sure all pieces are present and accounted for.

GS-94C-D PARTS

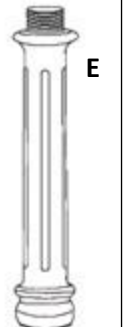
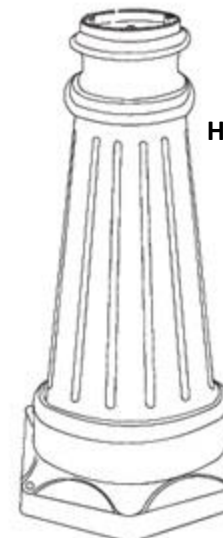
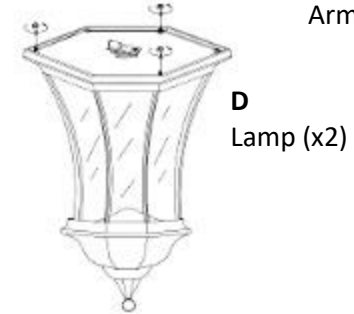
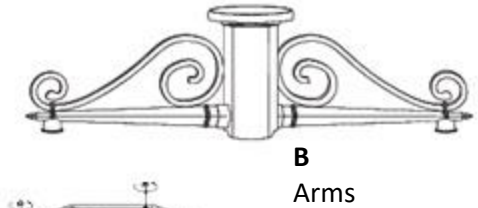
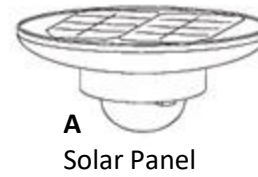

Assembly Instructions

Lamp Head

1. Remove the screws from the top of part A as shown (Fig. 1).
2. Connect the two black clips together from Part A to Part B (Fig. 2).
3. Place wires inside of Part B, attach Part A to part B using the screws from step one and Tighten them (Fig. 3).
4. Flip the assembly (AB) over and remove the nuts and washers from each side (Fig. 4).
5. Slide the wire from one side of Assembly AB through the hole in part C and set part C on the threaded rod (Fig. 5).
6. Slide washer and nut on threaded rod and tighten as much as possible with a 14mm wrench (Fig. 6). (Part C may twist slightly if pressure is applied, please note this is normal)
7. Repeat steps 5 and 6 to attach the other side.
8. Open the cover of Part D and assemble the bulb into the socket, close back the cover and do the same to the other one.
9. Connect the wire to the clip in part D (Fig. 7).
10. Connect Parts D and C using the Phillips head screws provided (Fig. 8).
11. Repeat steps 8 and 9 for the other side.

Lamp Post

1. Use an electric drill to make three holes in concrete, which should be similar to but slightly larger than the concrete anchors. The holes should be lined up with the holes of the lamp base (H).
2. Place the anchors into the drilled holes with their threaded ends facing up.
3. Place lamp base (H) onto anchors (Fig 9) and secure base with the washers, lock washers and nuts using a wrench. Cover the bolts with the plastic covers provided (Fig. 10).
4. Make sure the lamp base (H) is stable before installing Part G.
5. Place Part G on top of Part H and tighten with the provided screws using a wrench (Fig.11).
6. Screw Part F into Part G, Part E into Part F, and the lamp head assembly onto Part E (Fig. 12).



Fig. 1

Fig. 2

Fig. 3

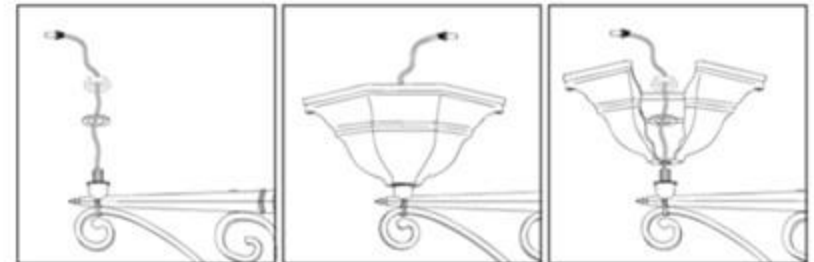

Fig. 4

Fig. 5

Fig. 6



Fig. 7

Fig. 8

Fig. 9



Fig. 10

Fig. 11

Fig. 12